

DT SERIES DESIGN RESOURCE GUIDE

IMPORTANT CONSIDERATIONS FOR DT SERIES SPECIFICATIONS



YOUR GUIDE TO THE SPECIFICATION AND DESIGN USE OF DURAFORM TEXTURED CABINETS

This guide was created to help designers anticipate various details encountered when specifying Waypoint’s Duraform Textured Cabinets. It illustrates the finished results so you can visualize all the details, manage homeowner expectations and more easily create exactly what you had in mind.



DT24 Duraform Breeze



DT24 Duraform Drift & 650 Painted Harbor



DT22 Duraform Cascade

TABLE OF CONTENTS

- DT Design Considerations4
- Available DT Textures4
- Side Treatments6
- Exposed Sides.....7
- Corner Cabinets8
- Blind Corner Cabinets8
- Microwave, Deep Sink Base and Oven Cabinets9
- Returns and Fillers.....9
- Molding..... 10
- Toe Kick 11
- Non-Textured and Exposed Frame SKU 12
- Duraform Texture Accessories SKUs 13
- Have a Question? Contact Us 14

DT SERIES DESIGN CONSIDERATIONS



DT24 Duraform Breeze



DT22 Duraform Drift



DT24 Duraform Drift & 650 Painted Harbor



DT22 Duraform Cascade

DT SERIES DESIGN CONSIDERATIONS

IMPORTANT CONSIDERATIONS FOR DT SERIES SPECIFICATIONS

- › Door and drawer fronts are the only part of the cabinet that is textured
- › Determine if you are designing to complement the box finish or the textured finish when using end panels
- › Specialty cabinets
 - With Specialty Door cabinets, the matching interior matches the complementary cabinet box
 - Some specialty cabinets are not textured
 - Cabinets with cut outs have more face frame exposure
- › Limited accessories with texture
- › Moldings are limited in the texture finish
 - Moldings are not wrapped completely and cannot be flipped
- › End run/exposed Toe Kicks should be recessed to separate horizontal grain from vertical grain on the cabinet end panel
- › Touchup material matches the complementary box finish

AVAILABLE DT TEXTURES

Relying on today’s latest technologies, these stylish textures have been created for long-lasting and durable use. This range of finishes bonded to composite wood appeal to the designer and homeowner alike with their versatility and ability to create a range of today’s latest styles.



DURAFORM BREEZE
With subtle striations of white and neutral tones, this textured finish makes a beautiful statement. This textured door style sits on a complementary Painted Linen cabinet box and exudes a sense of style and grace and works well for the creation of many unique styles.



DURAFORM DRIFT
With a remarkable likeness to a faded driftwood, this textured door style looks naturally amazing. Placed on a complementary Painted Harbor cabinet box, this textured door with its ridges and grooves captures the look of natural driftwood and can enhance any space in your home.



Duraform Cascade
This rich, deep-textured door style sits on a complementary Maple Espresso cabinet box and creates a dramatic look that will last for years to come. This textured door style with its rich contrast serves as the perfect backdrop for kitchens, baths or any other living space.



Duraform Breeze
Box Color: Painted Linen



Duraform Drift
Box Color: Painted Harbor



Duraform Cascade
Box Color: Maple Espresso

SIDE TREATMENT OPTIONS



Plain cabinet side
(1/4" reveal)



Furniture End
(flush side)



WWBEP2534 DT
1" extended pass face frame



BEP34 DT
3/4" Face Frame Edge Exposed



BEP34 DT with DMDB
7/32" Face Frame Edge Exposed



FE with DMDB
7/32" Face Frame Edge Exposed

EXPOSED SIDES



Wall Cabinet with WEP DT



Wall Cabinet with WEP DT & SM8 DT

EXPOSED SIDES

REMEMBER EXPOSED SIDES ARE THE COMPLEMENTARY FINISH.

- › You must determine if you are designing to complement the box finish or the textured finish
- › When adding a 9/64" skin the 3/4" face frame will still be exposed
 - Recommend using SM8 to cover the face
- › When adding a 3/4" end panel the face frame will be covered
 - Remember the 3/4" textured end panels (DT) are deeper than the cabinet. You will have to determine if you want them at the same depth of the cabinet or flush with the door



GREEN indicates exposed side

YELLOW indicates side of face frame

CORNER CABINETS

- › We do not recommend using the Corner Wall cabinet (e.g. CW2430 and CBS36 _) due to the amount of face frame that is exposed
 - If you have to use the 27” deep Corner Wall cabinets, remember the exposed side and face frame edge
- › We recommend using the Wall Easy Reach and Base Super Susan or Base Easy Reach (e.g. WER30_ and BSS_, BER_, CAR_)



Picture shown with CW2742 with WEP1542 DT

MICROWAVE, DEEP SINK BASE AND OVEN CABINETS

- › Be aware of face frame exposure. Microwave, Deep Sink Base and Oven cabinets will have exposed face frame
 - Check the appliance size to be sure you are using a cabinet that will show the least amount of face frame
 - Picture shows a OVD3396 AS BUTT, a better option would have been a OVD3396 BUTT 1 DDWR



Picture shown with OVD3396 AS BUTT

BLIND CORNER CABINETS

- › When using a blind corner cabinet, you will want to use an Overlay DT filler to cover the exposed frame



Picture shown with no overlay on filler



Picture shown with overlay on filler

RETURNS AND FILLERS

- Dishwasher and Refrigerator Returns and Universal Fillers (e.g. DWR3, RR396 and UF's) are not textured
- › You must determine if you are designing to complement the box finish or the textured finish
 - If designing to match the textured finish, use the available DT end panels and overlay fillers to cover exposed frame and filler areas
 - › Textured S3S396 DT and S3S696 DT can be trimmed and edge banded with edge tape on the trimmed side



Picture shown with RR396 and S3S396



Picture shown with recommended overlay on DWR3

MOLDING

- › When using the WWP13_ DT ¾” End Panels at 13” deep or DWTEP_ DT at 25” Deep, you will need to remember there is a 1” gap
- › To fill the gap use S3S396 DT horizontal flush with the ¾” End Panel
- › The S3S396 DT horizontal molding can be used alone for a contemporary look or enhanced with additional molding such as ACM8 DT, SCVM8 DT OR LCVM8 DT
- › Moldings are not wrapped completely and cannot be flipped

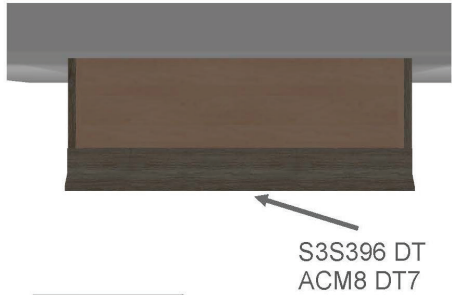
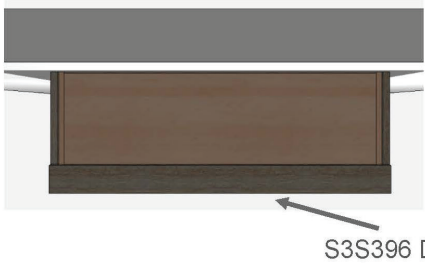
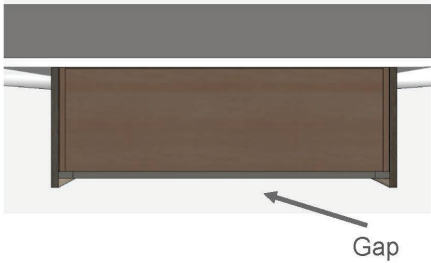

MOLDING—FINISHED SIDES

- › Refer to Spec Guide call outs for finished sides of molding
- › Molding is not fully wrapped and cannot be flipped
 - i.e. CTM8 DT cannot be used in a vertical application, only laid flat



TOE KICK

- › Consider using recessed toe kick for all end run and exposed toe kick applications to avoid the horizontal grain butting up against the vertical end panel of the cabinet



NON-TEXTURED AND EXPOSED FRAME SKUS

WALL	BASE	TALL	DESK	VANITY	PANELS, FILLERS, DECORATIVE ITEMS
Wall Microwave	Deep Sink Base	Single Oven Cabinets	Kneehole Drawer	Valet Cabinet	Dishwasher/ Refrigerator Return
Wall Compact Microwave	Corner Sink Base	Double Oven Cabinets	Shelf Under Cabinet Organizer	Kneehole Drawer	Desk End Panel
Blind Wall	Corner Sink Front		Storage Cube	Tri-View Mirror	Grooved Panel
Corner Wall	Corner Base		Base Bookshelf		Wood Base End Panel (24" Deep)
Spice Drawer Cabinet	Base End Angle		Wall Bookshelf		Wood Tall End Panel (24" Deep)
Storage Cube	Base Bookshelf		Tall Bookshelf		Valances
Corner Appliance Garage	Base Spice Drawer				Corbels
Wall China Cabinet	Base Wine Rack				Legs
Wine Rack Cabinet	Shelf End Base				Feet
Wine Storage Cabinet	Shelf End Peninsula Base				Floating Shelves
Wall End Angle	Base Microwave Cabinet				Universal Filler
Shelf End Wall	Base Oven Cabinet				Base Corner Filler
Range Hoods	Furniture Drawers				Wall Column Filler
Range Hood Chimney	Blind Corner Peninsula				Base Column Filler
Wall Plain Box Filler					Tall Column Filler
VDO Cabinets					Fluted Beaded Filler
SD Cabinets (opaque glass only)					Stem Glass Holder
					Wine Rack
					Split Posts & Blocks
					Furniture Toe Kick
					Sink/Vanity Front Return
					Decorative Blocks
					Countertop Supports

DURAFORM TEXTURE ACCESSORIES SKUS

Finished Shelf:			
	FS4812 DT	FS6012 DT	FS7212 DT
Finished Paneling:			
	FP4834 DT	FP4896 DT	FP9634 DT
End Panel Skins:	Base	Wall	Tall
	BEP34 DT	WEP30 DT	TEP84 DT
		WEP42 DT	TEP96 DT
		WEP48 DT	TEP120 DT
		WEP1542 DT	
¾" Wood End Panels:	Base	Wall	Tall
	WBEP2534 DT	WWEP1330 DT	DWTEP84 DT
		WWEP1336 DT	DWTEP96 DT
		WWEP1339 DT	DWTEP120 DT
		WWEP1342 DT	
		WP9648 DT	
Overlay Fillers:	Base, Desk, Vanity	Wall	Tall
	BOF3 DT	WOF312 DT	TOF384 DT
	DOF3 DT	WOF315 DT	TOF390 DT
	VOF3 DT	WOF318 DT	TOF393 DT
		WOF321 DT	TOF396 DT
		WOF324 DT	
		WOF327 DT	
		WOF330 DT	
		WOF336 DT	
		WOF339 DT	
		WOF342 DT	
Molding:	Crown	Crown, Light Rail, Solid Stock	Toe Kick, Specialty
	ACM8 DT	CTM8 DT	BTK8 DT
	LCVM8 DT	S3S396 DT	OCM8 DT
	SCVM8 DT	S3S696 DT	QM8 DT
			SM8 DT
Miscellaneous:	Edge Banding	Bumpers	
	Edge Band 25 DT	Bumper Clear DT	
	Edge Band Tape 50	Bumper Clear 55 DT	

HAVE A QUESTION?

Contact the Partner Team or your Territory Business Manager for any questions or further details.

Phone: 877-957-7278

Fax: 877-957-7277

Email: partners@waypointlivingspaces.com

Hours of Operation: Monday through Friday
8:00 AM - 8:00 PM EST

waypointlivingspaces.com



Waypoint[®]
LIVING SPACES

Exactly what you had in mind[®]